



Kusch + Co



Colebrook Bosson Saunders

Rhein and Reason

When we started out in this market there were many, many things that would, in hindsight come as a massive surprise to us. We didn't really think we'd become so involved, so fond and so influential (even if we say so ourselves!). We also didn't expect to meet so many brilliant, lovely people - clients, designers, salespeople, architects, end users...friends. And one thing we really weren't expecting was that our most visited city outside the UK would be Cologne.

Two years on, and we're heading back to the noble German city once again as the office furniture stopwatch ticks around to Orgatec o'clock once more. Yep, if you haven't marked 'Cologne' in your diary from 26-30 October, then you'd better get a wriggle on.

Despite the state of the economy, the major protagonists are once again offering a great deal in terms of sparkly new stuff. We're not sure how much R&D spend has been cut, but judging by the (virtual) sackloads of press releases we've been getting in, there's certainly been a few Euros handed over to the designery ones.

Orgatec is of course a major event – the biggest we've got. It might not be at the mega-show level of a few years back, but it's certainly still a super-show. There's plenty to feast your senses on away from the product developments (and no, we're not talking about chilled Kolsch bier in the Alter Markt). The Messe also throws out a good amount of interesting stuff to see and do – even for specifiers and academics.

When it comes to green building and sustainability, revitalisation of real estate or concepts for 21st century offices and workplaces, there is an equal need for architects and interior designers alike.

These trend themes will also be in the spotlight at Orgatec. The event offers not only the exhibitors' latest developments and solutions, but also an array of supporting programme highlights that will be of special interest to planners.

These features range from the Architects' Breakfast and the Architects' Lounge (situated in the Orgatec Boulevard) to Insight Cologne – Orgatec Night of Corporate Architecture, the Ultima Office Trend Forum and the presentation of the BDIA prize for young interior designers.

Of course, the chief reason for most to head out to Germany is to check out the ▶▶▶▶▶

PREVIEW ●●●



Andreas Störiko and Wilkhahn have also been busy transforming conference furnishings. Premiering in Cologne is Timetable Shift, which combines the swivel-tabletop principle with the award-winning design of Logon and the Confair folding table. The two table legs with double uprights and foot sections on lockable wheels are connected under the tabletop with a horseshoe-shaped aluminium profile, providing stability for larger tabletop sizes and a generous-sized cable channel for equipment. Multi-purpose chair Chassis, designed by Stefan Diez, is another sensation we can expect from Wilkhahn. For the first time, space-frame technology has been used in a chair. The robust seat and back frame and connecting elements on the four legs are deep drawn from sheet metal in one and joined by welding robots to form a complete frame.

The new ON conference chairs will be celebrating their world premiere too. The new models have four-star bases that foster an orderly and uncluttered look around the conference table. Some 27 models are available, with three backrest heights, three types of cushions and three different armrest pads to match the level of company seniority and interior design.

Fellow Germans Sedus will be bringing its 'Productive well-being in Place 2.5' concept to life over an impressive 1,200 sq m super-stand. The Orgatec focus will be on seminar and conference furniture with integrated media technology and a comprehensive new office furniture range. The complementary desk and storage unit system for working areas and upholstered furniture, high desks and screen elements for middle zones allow both open plan and combi offices to be perfectly furnished.

The Sedus stand has been designed as a holistic experience for the senses which shows in impressive style that, alongside exemplary furnishings, there are many other aspects which need to be taken into account in order to create a feeling of well-being. Partners from the 'Office of the Senses' will be offering professional solutions for media technology, acoustics, indoor climate, lighting, the use of scents and greenery.

grand slam, meanwhile, is a universal storage system. It provides space for everything one needs in the office. grand slam transforms storage units, shelving and pedestals into design features with endless creative possibilities – there are even partitions and add-on modules, and new functional components, like the swivel-out

►►► bewildering array of fresh and exciting product innovations on display over the hectares of show space. So, here's a quick guide to just a few of the main protagonists.

Wilkhahn's Aline range, designed by Andreas Störiko, previously available as multi-purpose chairs or counter stools,

visitor seating, swivel chairs or benches, side tables or high tables in cafeterias, has now been updated to include rectangular tables. Five table sizes offer different solutions, spanning compact desks to multi-purpose cafeteria or seminar tables, to the single dining table, or conference tables or desks.

PREVIEW ●●●



Gotessons



Connection



Camira

►►► communication element that forms a variable meeting table.

match up is the big brother of the match swivel chair, and has a height-adjustable backrest, a depth-adjustable lumbar support and an optional headrest. The patented 'independent fit' technology automatically adjusts the contour of the backrest to upper body movements: when one leans back, the headrest gently curves forward into the body's natural head and shoulder position. When sitting up, it realigns itself automatically to best suit an upright sitting position.

Girsberger will once again be showing at this year's Orgatec fair and will launch four new products including a new entry level task chair family together with stylish breakout/meeting room seating – all aimed at turning some heads of course – whilst the only early news from Vitra we have received is of a collection of new Eames Plastic Chairs with Upholstered Shells.

The trendsetting Porsche Design Studio team has combined its know-how with the experience and expertise of Kusch + Co to create an innovative bench series, meeting all the specific requirements of waiting rooms. Series 8000 promises to be one of

the stand-out launches of the fair, and promises a new aesthetic design language and, as with all Kusch products, quality engineering.

Bene will be presenting the RM Room Module, the ultimate room divider for open office landscapes, as one of its new products at Orgatec. The RM Room Module, designed by Johannes Scherr, segregates offices, encourages cooperation and communication, and creates a comfortable working environment while also being efficient in terms of floor space. The heart of this room divider is a stable aluminium frame that can be expanded on both sides with panels, boxes, shelves, desks and other furnishings: it's everything from a dividing wall with acoustic value to a perfect workplace. 'The challenge was to do something worthwhile with the notion of the dividing wall and to expand and enhance it for functions such as storage and desks, thus saving both material and space,' says Johannes Scherr.

Casala will be unveiling an intriguing new collection at this year's show. Parker is described as 'One chair and 30 different frame options to compliment it'. Frames are manufactured from various materials to

offer fixed, cantilever and swivel options. Parker will feature along with further new ranges for the Casala collection.

Interstuhl, with its brands bimos, Interstuhl and prosedia, will once again be making a big appearance at Orgatec. Following the original and multi-award-winning fair booths of past events, Interstuhl has this year decided on an open architecture that summarises the key aspects of modern sitting under the theme of movement. A dynamic, moving band unfolds expressively over the 1,500 sq m of exhibition space and will guide visitors to the individual exhibits by means of coloured and spatial effects.

Probably the most unusual innovation that Interstuhl will be presenting is Vol.8, a series of office chairs that will change former expectations and conventional patterns of perception in this product sector. The designers from designship in Ulm have developed a swivel chair whose seat is deliberately characterised by a capacious volume. The company has said goodbye to the former principle of showing all of the technology in a functional style beneath the seat. In Vol.8 the technology is assumed to be obvious without having to be shown.►►►►►

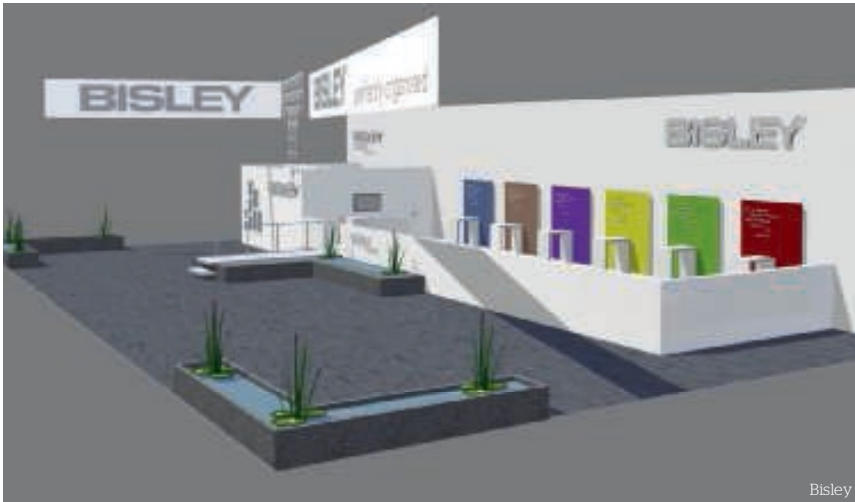

Bisley



Interstuhl

adjusts to the needs of each user, offering appropriate levels of resistance without unnecessary locks, dials or manual controls.

Paramount, Humanscale's ultra-advanced multiple-monitor mounting system, will also be on display. Specifically designed for the trading desk environment, Paramount is described as the easiest, most flexible way to display multiple monitors in a dynamic environment.

Humanscale will also debut its newest monitor arm solution – the M8 monitor arm. Through its unique and innovative design, the M8 offers incredible weight capacity within a sleek, slim profile that accommodates the widest range of monitors available today. Element 790, the upgraded version of the groundbreaking Element LED task light, features adjustable illumination and an expanded colour palette. Element 790 builds on the advancements of its revolutionary forerunner to take functionality and usability to new levels.

Haworth tells us the idea behind its Orgatec stand is to create an exemplary organic workspace that demonstrates to visitors different work settings for different tasks and proactively supports different working styles and needs. At the same time, the us giant hopes to show you how workspaces can motivate employees and invite them to socialise easily, communicate well and be productive.

Haworth also tells us that we will experience an environment that puts human beings at the heart of the creative workspace process, in the Collaboration Heart – for socialising and communicating, the Lounge Space – for working and socialising, and the Seating Area – where ergonomics is applied to perfection.

Orgatec will also see the launch of Werner Works' new counter system – basic C which has been developed to complement the popular basic S system. The innovative new concept stand, inspired by the new product range, will also be well worth checking out.

Following a predictably strong show at NeoCon, the Herman Miller stand will once again be a must-see. Expect European launches of the best of their wares from Chicago, plus, no doubt, a surprise or three.

Frem/Kokuyo have a whole range of new products for you to check out at Orgatec, including the IBUKI office chair. Paving the way for a new era of comfort and style, the chair is innovatively designed with the advanced functionality of air controlled lumbar support, breathing mesh and heat dispersing cushioning.

And speaking of Eastern promise, check out the Okamura stand, where a number of new product developments are expected.

Vetroin conjugates innovative technology and top design with glass... in order to build a functional environment with elegance and comfort. The Truelight and Evolvinwall interior partition systems fit easily into any modern architectural situation, featuring a range of excellent materials and finishings, including a range of glass printing technologies.

Gotessons will unveil the ScreenIT Standard at the show. This competitively priced acoustic desktop screen features a tailor-made combination of fabric, zippers or seams to order, and is produced in MDF with a replaceable laminated fabric coating to extend its life cycle. The system is 100% recyclable, noise absorbing and fireproof.

ScreenIT Breeze, meanwhile, is a personal, modern, sound absorbing table

screen, with 'a la carte' fabric and zipper colour choice, combined with directional energy saving LED lights.

To mark the UK consumer launch of the Campaign for Wool, which even included the turfing of Savile Row and sheep grazing in central London, Camira will be launching several new high end wool fabric collections. There's a mouthwatering collaboration with Mixology North Designer of the Year David Fox, whose debut into textile design sees the launch of Adrenalin, a graceful jacquard featuring a swirling, seductive, converging interlace, and the more angular Nuna, inspired by jagged ridges and dramatic ice fields. There's also the reinterpretation and resurrection of classic, rugged wool fabric Craggan, and a distinctive Gaelic wool tartan called Blazer Check.

That should be enough for you to be getting on with. Recession? What Recession? ●



Wilkhahn